

Grabungspläne

Übersicht der Profile

Profil-Nr.	Lage des Profils	Profilzeichnung
1	Schnitt 1	
2	Schnitt 1	X
3	Schnitt 2	X
4	Schnitt 2	X
5	Schnitt 2	X
6	Schnitt 1	X
7	Schnitt 1	X
8	Schnitt 3	X
9	Schnitt 3	X
10	Schnitt 1/2	X
11	Schnitt 1/4	
12	Schnitt 4	
13	Schnitt 1/4	
14	Schnitt 1/4, 4	X

Burladingen St. Georg Gesamtübersicht

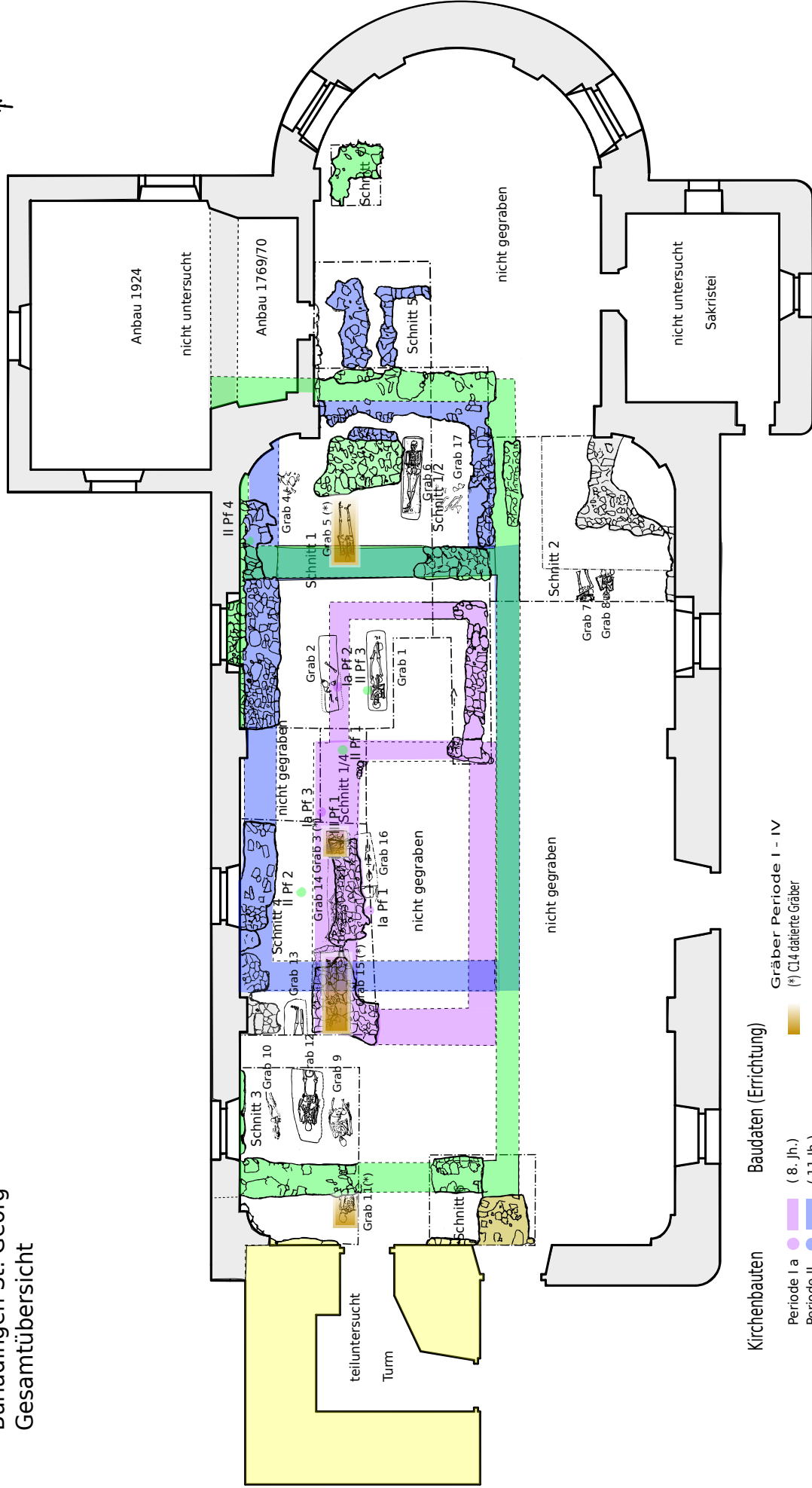

- Kirchenbauten**
- Periode I a (8. Jh.)
 - Periode II (11. Jh.)
 - Periode III (12./13. Jh.)
 - Periode III a (Anfang / Mitte 15. Jh.)
 - Periode III b (15./16. Jh.)
 - Periode IV (1769/70) (Anbau 1924)
- Baudaten (Errichtung)**
- Gräber Periode I - IV
 - (*) C14 datierte Gräber



Burladingen St. Georg Übersicht der Profile

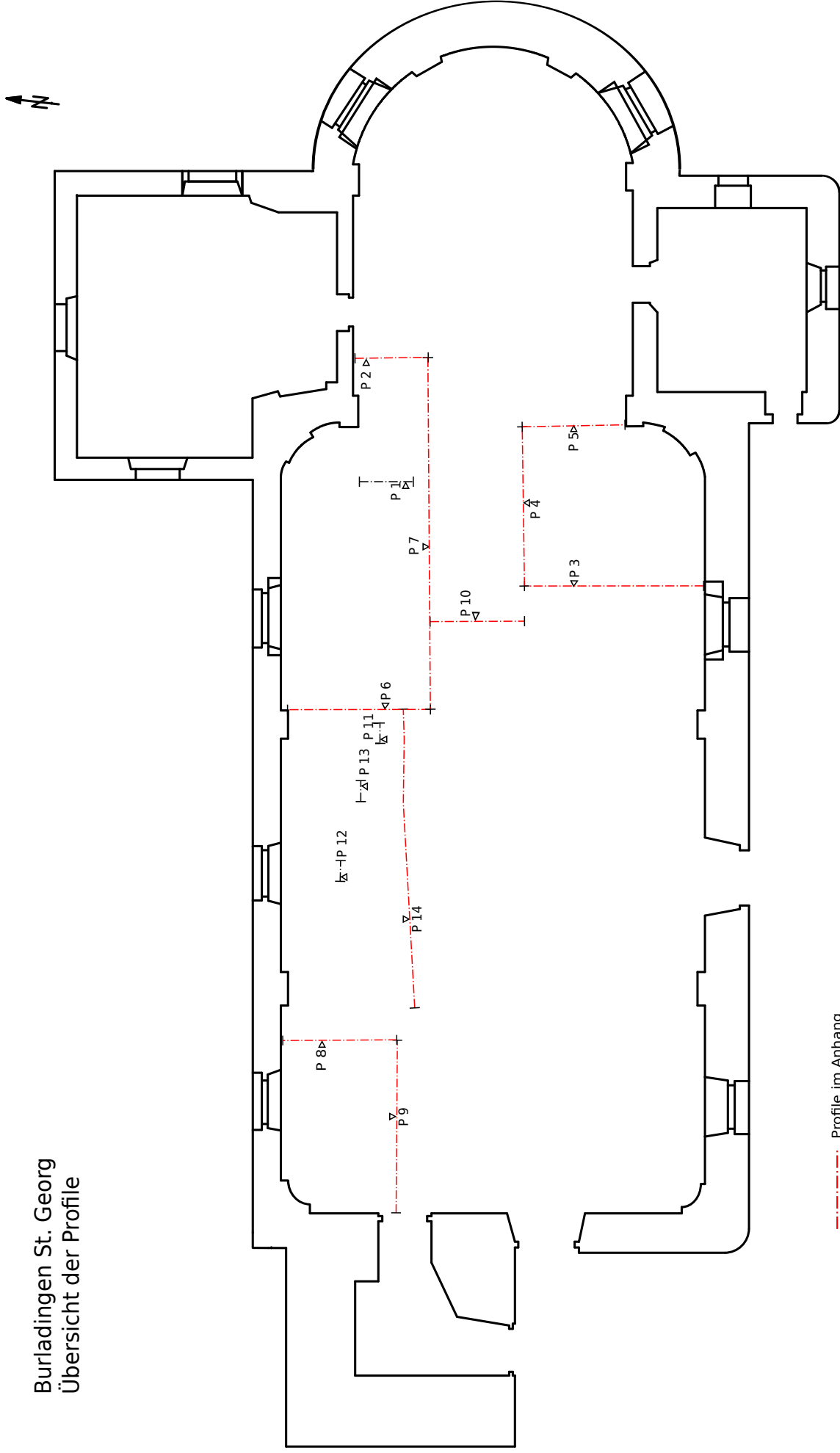

--- Profile im Anhang



Burladingen St. Georg Übersicht der Schnitte

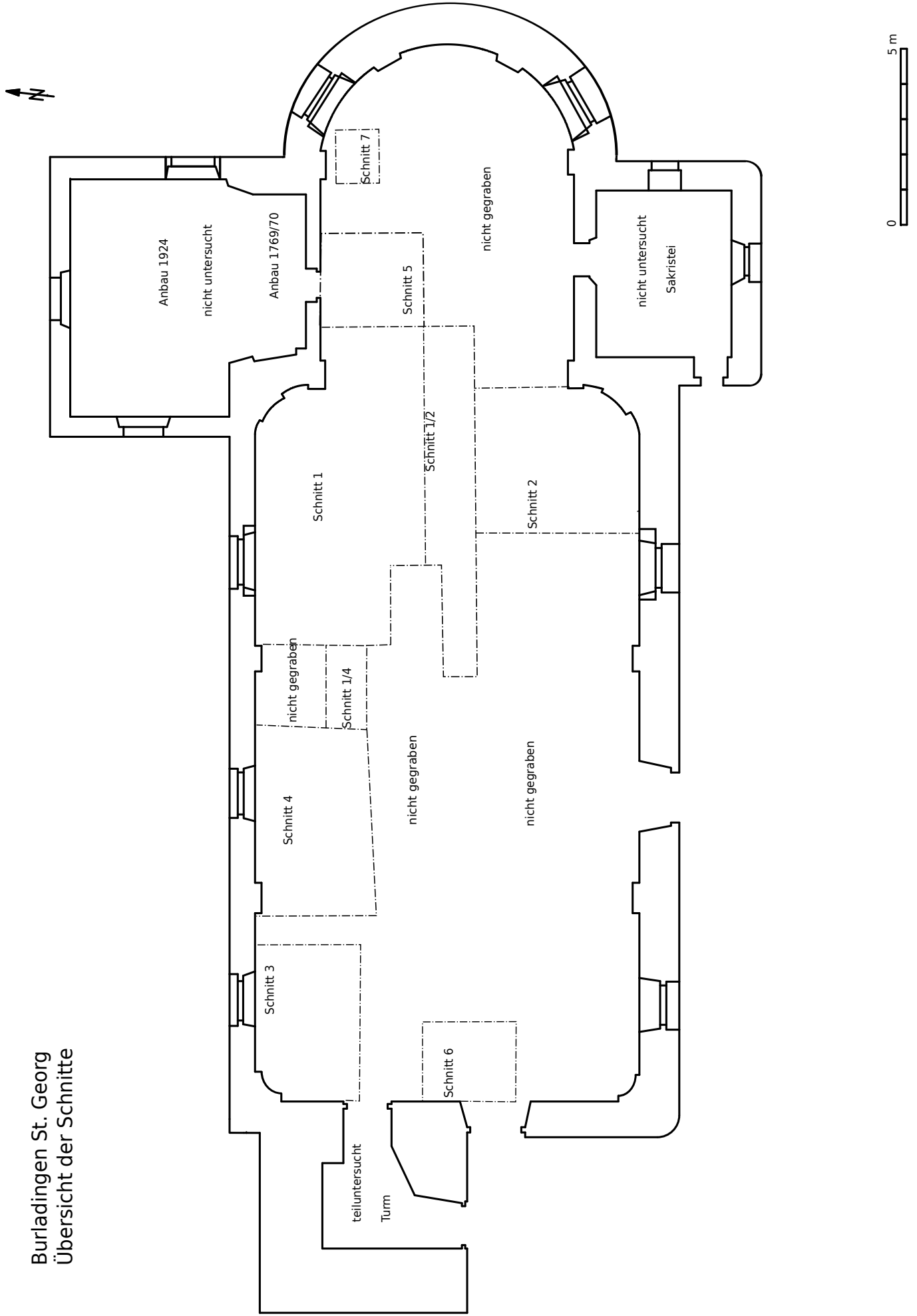

Burladingen St. Georg Meßnetz

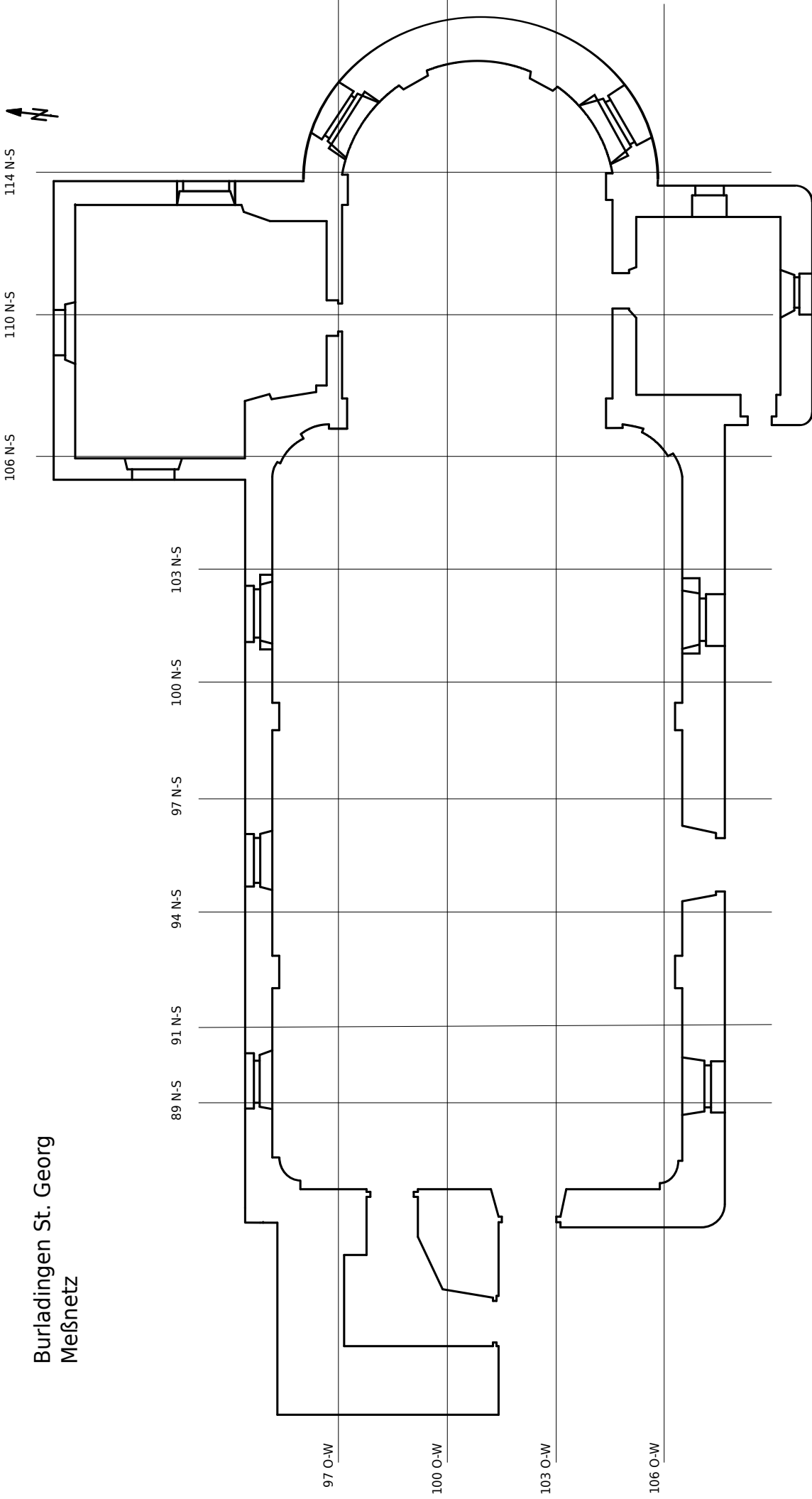

Burgruine St. Georg
Profil 2

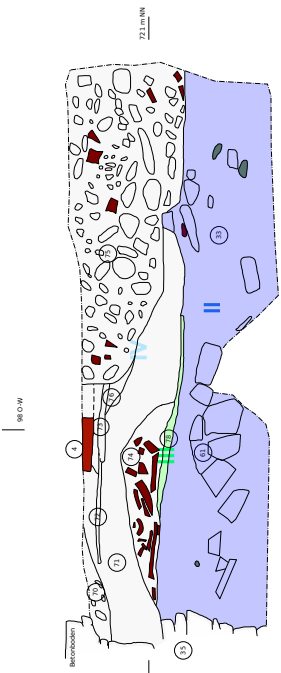

Burgruine St. Georg
Profil 5

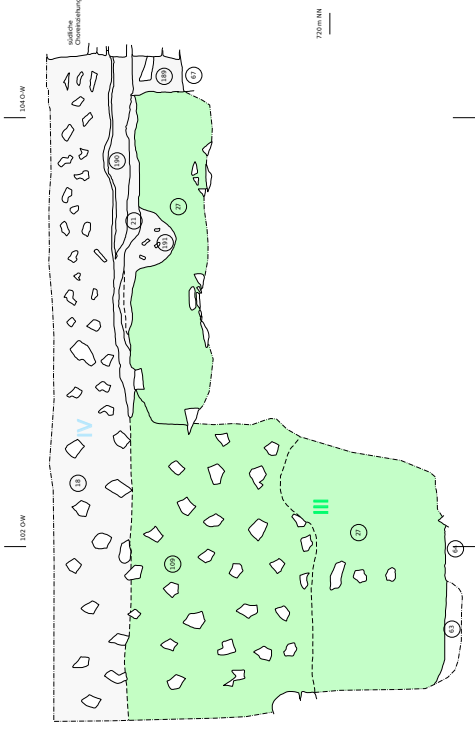

Burgruine St. Georg
Profil 3

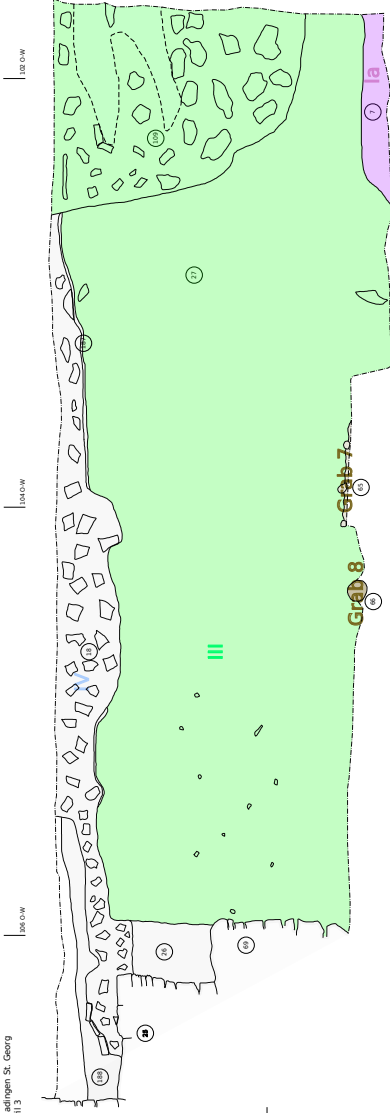

Burgruine St. Georg
Profil 4

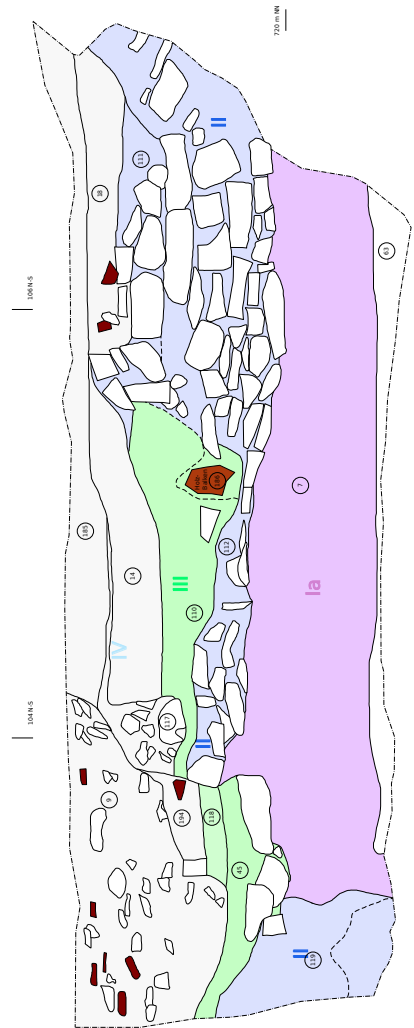

Burialdungen St. Georg
Profil 6

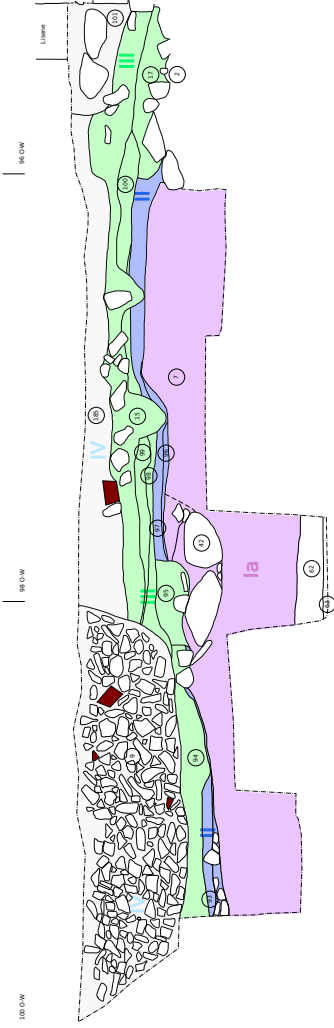

Burialdungen St. Georg
Profil 7

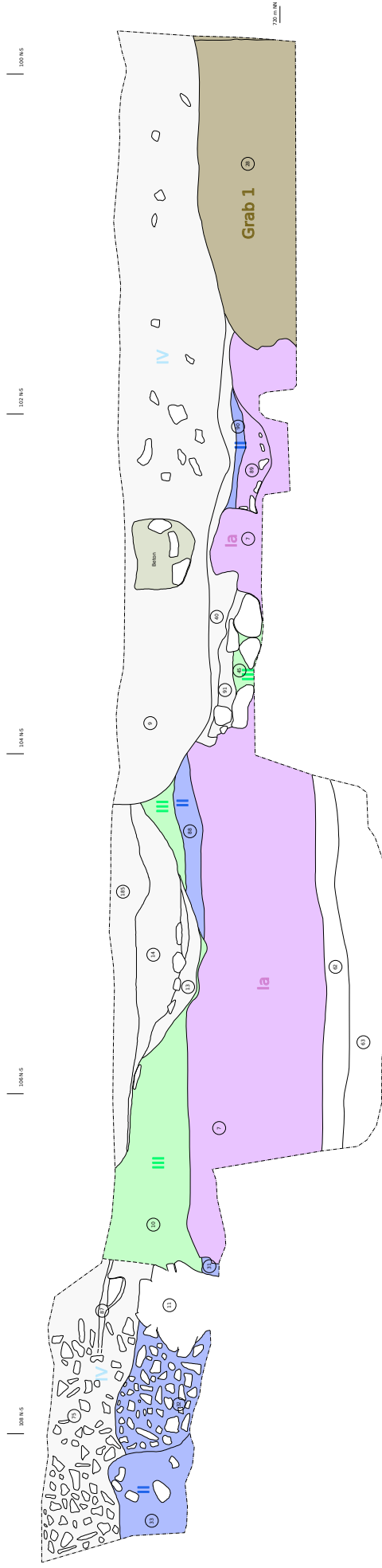

Burialdungen St. Georg
Profil 8

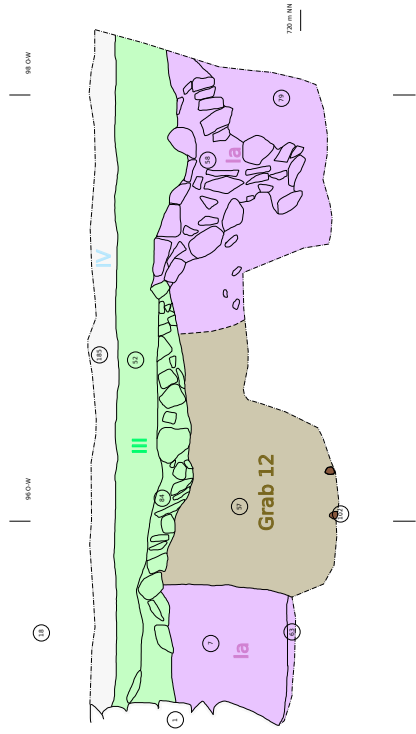

Burial site St. Georg
Profile 9

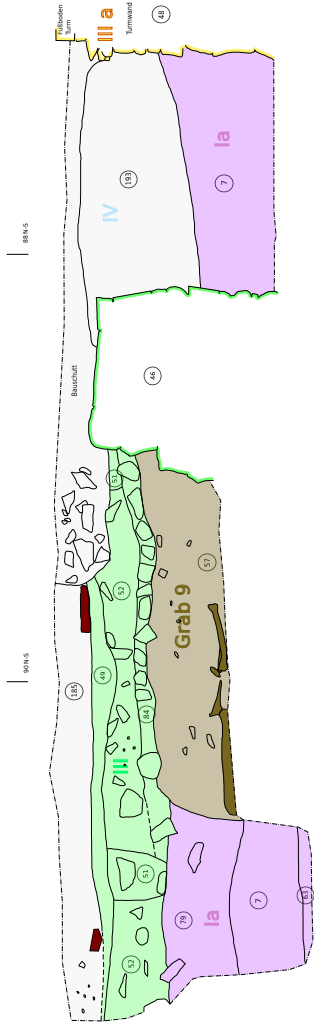

Burial site St. Georg
Profile 10

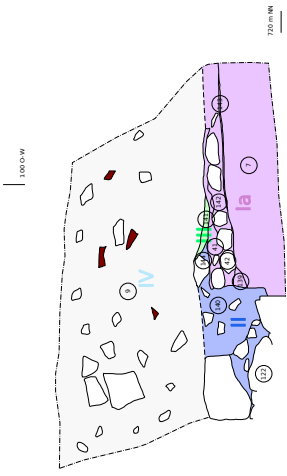

Burial site St. Georg
Profile 14

